

680 DOOR CLOSER



Tested to EN 1154 **483113** **482113**

by Warrington APT Laboratories, UK

Power Adjustable #2 to #4 by Position / by Springs

EN Fire Tested

DORINT 680 OVERHEAD DOOR CLOSER

NUMBER: 1121-CPR-AD0143

DATA AND FEATURES

		681	680	6825	6836
Variable closing force	Spring strength (EN)	1 to 2	2 to 4	2 to 5	3 to 6
Standard doors	≤750mm ≤20kg	681	x	x	x
	≤850mm ≤40kg	681	680	6825	x
	≤950mm ≤60kg	x	680	6825	6836
	≤1100mm ≤80kg	x	680	6825	6836
	≤1250mm ≤100kg	x	x	6825	6836
	≤1450mm ≤120kg	x	x	x	6836
Body dimensions(mm)	Length	162	220	248	297
	Height	44	59	59	62
	Projection	36	42	42	46
Arm	Standard	√	√	√	√
	Parallel	○	○	○	○
	Track (standard)	○	○	○	○
	Track (hold-open)	○	○	○	○

√=yes

x=no

○=option



770 DOOR CLOSER

Power Adjustable #2 to #4 by Position

EN Fire Tested

by Warrington APT Laboratories, UK



DATA AND FEATURES		770
Variable closing force	Spring strength (EN)	2 to 4
Standard doors	≤ 750mm ≤ 20kg	x
	≤ 850mm ≤ 40kg	770
	≤ 950mm ≤ 60kg	770
	≤ 1100mm ≤ 80kg	770
	≤ 1250mm ≤ 100kg	x
	≤ 1450mm ≤ 120kg	x
Body dimensions(mm)	Length	178
	Height	42
	Projection	64
Arm	Standard	✓
	Parallel	○
	Track (standard)	○
	Track (hold-open)	○

385 SERIES



Power Adjustable #2 to #4 by Spring
 Thickness 37 mm
 Back Check [Optional]
 EN Fire Tested
 by Warrington APT Laboratories, UK

380 SERIES



Power #1, #2, #3,
 Thickness 32 mm
 EN Fire Tested
 by Warrington APT Laboratories, UK



DATA AND FEATURES

		380	385
Variable closing force	Spring strength (EN)	1 to 3	3 to 5
Standard doors	≤ 750mm ≤ 20kg	381	x
	≤ 850mm ≤ 40kg	382	x
	≤ 950mm ≤ 60kg	383	385
	≤ 1100mm ≤ 80kg	x	385
	≤ 1250mm ≤ 100kg	x	385
Body dimensions(mm)	Length	230	239
	Width	57	61
	Thick	32	37
Arm	Standard	x	x
	Parallel	x	x
	Track (standard)	✓	✓
	Track (hold-open)	✓	✓



750 FLOOR HINGES

Power adjustable by springs from #1 ~ #4

Narrow design

10 years guaranteed

DATA AND FEATURES

		750
Variable closing force	Suitable door width	1 to 4
Standard doors	#1 ≤ 750mm	750
	#2 ≤ 850mm	750
	#3 ≤ 950mm	750
	#4 ≤ 1100mm	750
Body dimensions(mm)	Length	274
	Width	82
	Thick	50
Arm	Standard	✓
	Offset arm	○
Cam-action		✓
Angle of opening		160°
Power adjustable by springs from #1 ~ #4		✓
Sweep speed adjustable		✓
Latching speed adjustable		✓
Hold-open	Without hold-open	○
	at 90° hold-open	✓
	at 105° hold-open	○
Back-check	Self-regulating	x
	Adjustable at valve	x
Delayed action adjustable		x
Non-handed		✓
Guarantee/years		10 years

✓ =yes

x=no

○ =option



840 FLOOR SPRING



Tested to EN 1154 **383113 384113**

by Warrington APT Laboratories, UK

Power #2, #3, #4

EN Fire Tested

DORINT 840 #3 Floor Spring NUMBER: 1121-CPR-AD0179

DORINT 840 #4 Floor Spring NUMBER: 1121-CPR-AD0207

DATA AND FEATURES

840

Variable closing force	Spring strength (EN)	2 to 5
Standard doors	≤850mm ≤70kg	842
	≤950mm ≤105kg	843
	≤1100mm ≤150kg	844
	≤1250mm ≤200kg	845
Body dimensions(mm)	Length	306
	Width	108
	Thick	40
Arm	Standard	✓
	Offset arm	○
Cam-action		✓
Angle of opening		130°
Sweep speed adjustable		✓
Latching speed adjustable		✓
Hold-open	Without hold-open	○
	at 90° hold-open	✓
	at 105° hold-open	○
Back-check	Self-regulating	x
	Adjustable at valve	○
Delayed action adjustable		x
Non-handed		✓
Guarantee/years		10 years

✓ =yes

x=no

○ =option



220 FLOOR HINGES

10 Years Guaranteed
Power #2, #3, #4



▲ STANDARD STRAP, TOP AND BOTTOM PIVOT

DATA AND FEATURES

220

Variable closing force	Suitable door width	2 to 4
Standard doors	≤ 850mm	222
	≤ 950mm	223
	≤ 1100mm	224
Body dimensions(mm)	Length	289
	Width	124
	Thick	51
Arm	Standard	√
	Offset arm	x
Cam-action		√
Angle of opening		120°
Sweep speed adjustable		√
Latching speed adjustable		√
Hold-open	Without hold-open	○
	at 90° hold-open	√
	at 105° hold-open	○
Back-check	Self-regulating	x
	Adjustable at valve	x
Delayed action adjustable		x
Non-handed		√
Guarantee/years		10 years

√ = yes

x = no

○ = option



850 TRANSOM CLOSER

10 Years Guaranteed

Power #2, #3, #4

DATA AND FEATURES

850

Variable closing force	Suitable door width	2 to 4
Standard doors	≤850mm	852
	≤950mm	853
	≤1100mm	854
Body dimensions(mm)	Length	271
	Width	87
	Thick	40
Arm	Standard	√
	Offset arm	x
Cam-action		√
Angle of opening		130°
Sweep speed adjustable		√
Latching speed adjustable		√
Hold-open	Without hold-open	○
	at 90° hold-open	√
	at 105° hold-open	○
Back-check	Self-regulating	x
	Adjustable at valve	x
Delayed action adjustable		x
Non-handed		√
Guarantee/years		10 years

√ =yes x=no ○=option

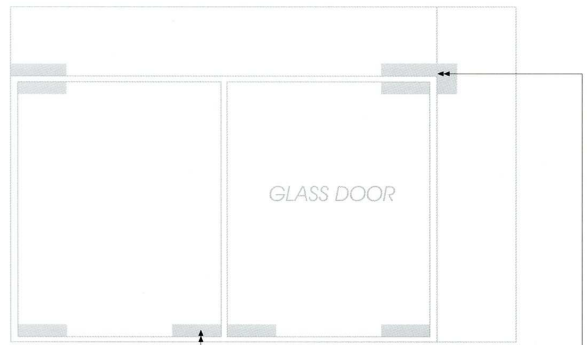
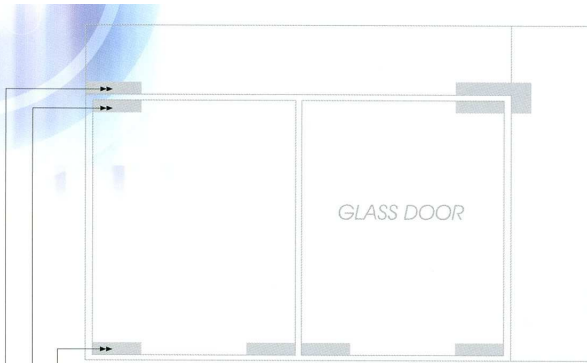

<DPF-3>
Bottom Patch

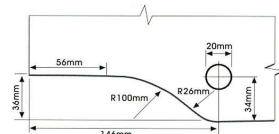

<DPL-1> Patch LOCK

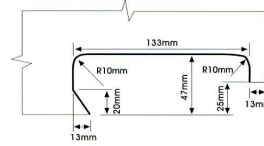

<DPF-2>
Top Patch

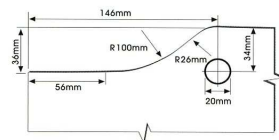

<DPF-1> SIDE PANEL CONNECTOR

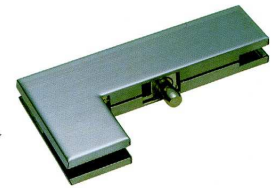
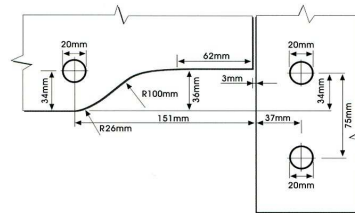

<DPF-4>
Overhead Pivot Patch

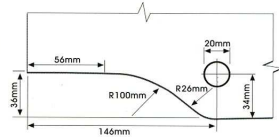
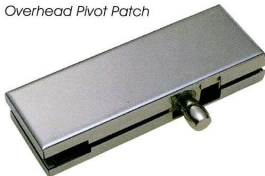



883

Tested to EN 1154 **383013**

DATA AND FEATURES

DFG883

Variable closing force	Spring strength(EN)	#3
Standard doors	≤ 850mm ≤ 100kg	883
	≤ 950mm ≤ 100kg	883
	≤ 1100mm ≤ 100kg	—
	≤ 1250mm ≤ 100kg	—
Suitable door thickness(mm)		8-13
Body dimensions(mm)	Length	182.5
	Height	68
	Projection	36
Angle of opening		150°
Power adjustable by spring		X
Sweep speed adjustable		✓
Latching speed adjustable		✓
Hold-open	Without hold open	○
	Hold open at 90°	✓
Non-handed		✓
Guarantee/years		5 years

✓ =yes x=no ○ =option

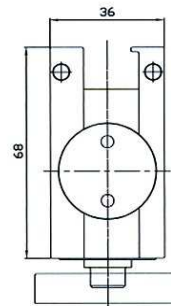
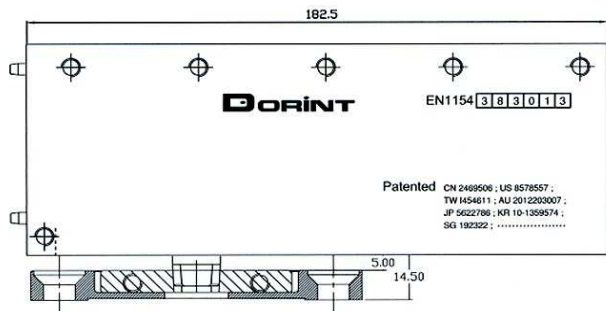



885

DATA AND FEATURES

DFG885

Tested to EN 1154 **385013**

Variable closing force	Spring strength(EN)	#5
Standard doors	≤ 850mm ≤100kg	—
	≤ 950mm ≤100kg	—
	≤ 1100mm ≤100kg	885
	≤ 1250mm ≤100kg	885
Suitable door thickness(mm)		10-15
Body dimensions(mm)	Length	192.5
	Height	77.5
	Projection	42
Angle of opening		150°
Power adjustable by spring		x
Sweep speed adjustable		✓
Latching speed adjustable		✓
Hold-open	Without hold open	○
	Hold open at 90°	✓
Non-handed		✓
Guarantee/years		5 years

✓ =yes x=no ○ =option

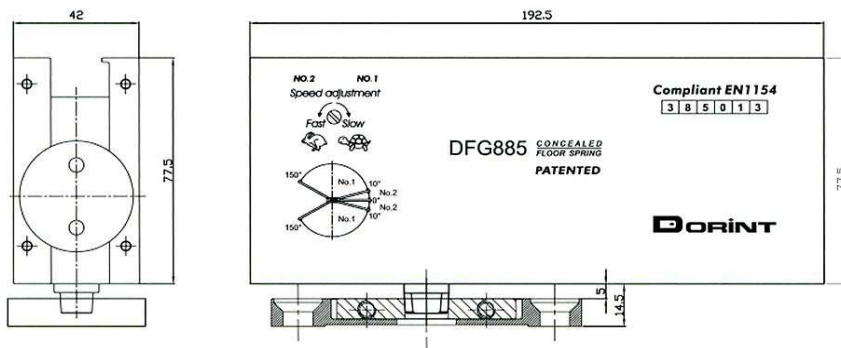



893

Conform to EN 1154 **383113**

DATA AND FEATURES

DFG893

Variable closing force	Spring strength(EN)	#3
Standard doors	≤ 850mm ≤ 100kg	893
	≤ 950mm ≤ 100kg	893
	≤ 1100mm ≤ 100kg	—
	≤ 1250mm ≤ 100kg	—
Suitable door thickness(mm)		≥ 40
Body dimensions(mm)	Length	181
	Width	56
	Thick	32
Angle of opening		150°
Closing speed adjustable		✓
Braking speed adjustable		✓
Hold-open	Without hold open	○
	Hold open at 90°	✓
Non-handed		✓
Guarantee/years		5 years

✓ =yes

x=no

○ =option

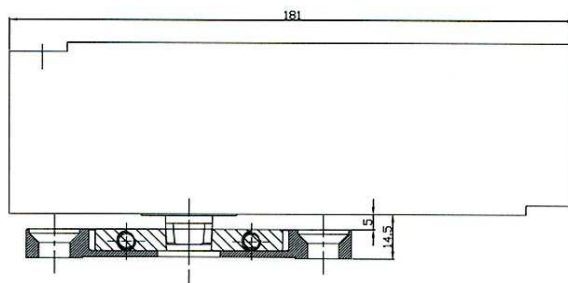
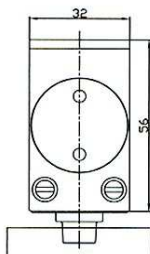



895

Conform to EN 1154 **385113**

DATA AND FEATURES

DFG895

Variable closing force	Spring strength(EN)	#5
Standard doors	≤ 850mm ≤ 100kg	—
	≤ 950mm ≤ 100kg	—
	≤ 1100mm ≤ 100kg	895
	≤ 1250mm ≤ 100kg	895
Suitable door thickness(mm)		≥ 50
Body dimensions(mm)	Length	184
	Width	64
	Thick	40
Angle of opening		150°
Closing speed adjustable		✓
Braking speed adjustable		✓
Hold-open	Without hold open	○
	Hold open at 90°	✓
Non-handed		✓
Guarantee/years		5 years

✓ = yes

x = no

○ = option

